

## 1 Circulation Desk

Check-out materials; register ID for off-campus access to resources; get course reserves, closed shelves, and multimedia materials; reserve a Group Study Room; send faxes; and much more.

## 2 Reference Desk

Ask questions, get research assistance.

## 3 Recreational Reading

New Books, Faculty Favorites, Newspapers, Paperbacks and new, casual furniture for relaxing.

## 4 Reference Collection

The place to start research: dictionaries, encyclopedias, almanacs, atlases, statistical sources, bibliographies on all subjects. These books are for use only in the Library, so they're always available.

## 5 DVDs

One of the most popular collections - classics, current hits, documentaries, and more.

## 6 Current Periodicals

Browse the newest issues of hundreds of magazines and journals on all subjects. Now with a larger seating area.

## 7 Library Classroom

Where librarians teach research techniques and information literacy.

## 8 Computer Lab

Largest collection of computers on campus. The library's computers include scanning stations and Macs. The English Department's Writing Center is in here (Rm. 239).

## 9 General Book Collection

Books that can be checked-out. Books with call numbers beginning with A - G are here, H - Z are downstairs.

## 10 Hawaiian Collection

Materials related to Hawai'i and the Pacific, including books, journals, maps, reprints, and more, along with reference assistance.

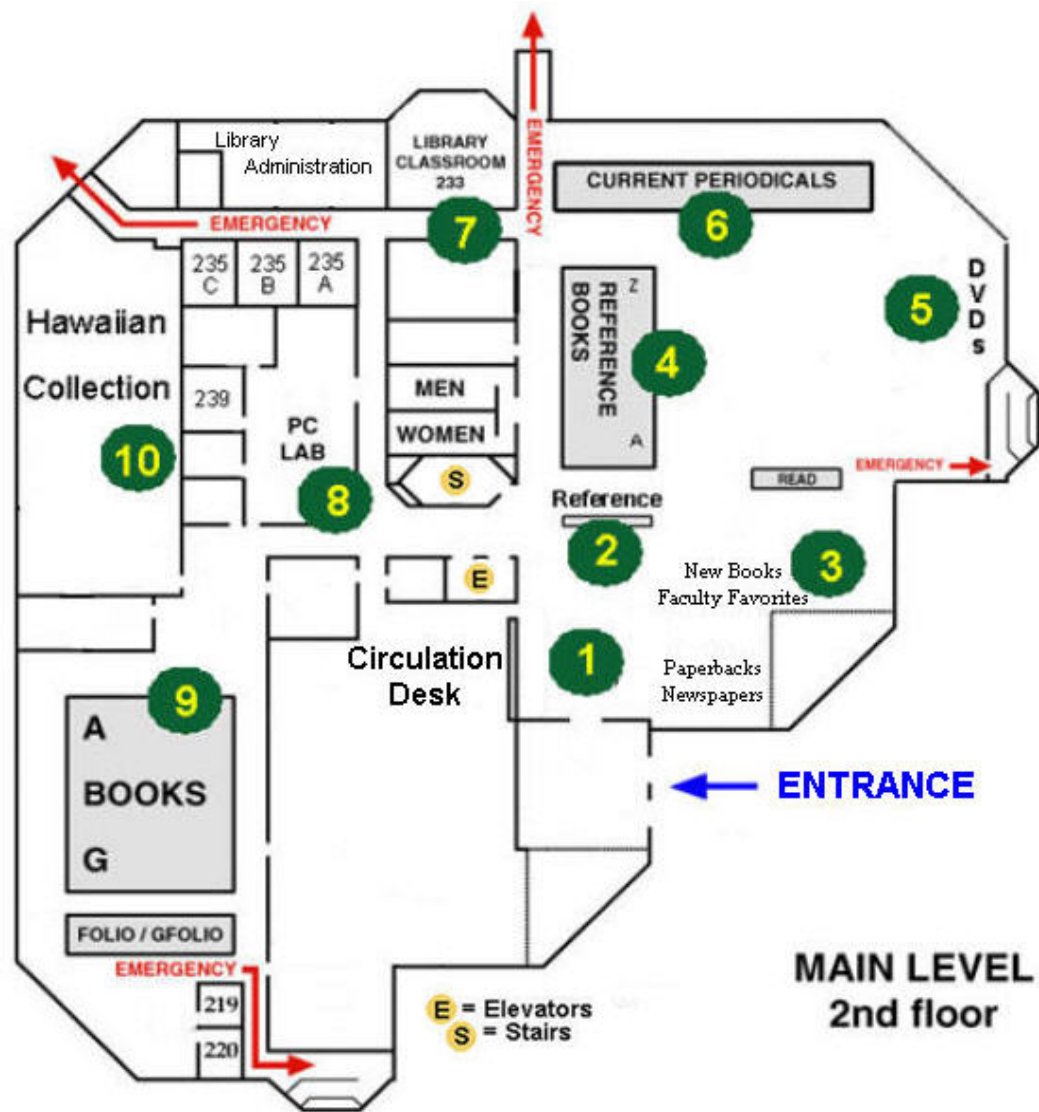

MAIN LEVEL  
2nd floor

**Periodical Backfiles**

Back issues of print journals, alphabetical by title.

**Government Documents**

Federal government documents including Congressional hearings, departmental publications, maps, periodicals, labor statistics, U.S. Census information, and more.

**Maps**

U. S. and World maps - most can be borrowed. Hawai'i maps are in the Hawaiian Collection on the Main Level.

